

Potentiometer

Series 8208



www.stahl.de



> Resistance values from 100 Ω ... 4,7 MΩ



07300E00

E4

The small Ex d enclosure 8208 can house potentiometers with a load capacity of 2 W.
For higher rated operational power, see potentiometer 8218.

	ATEX / IECEx					
Zone	0	1	2	20	21	22
For use in		x	x			

WebCode 8208B

Potentiometer

Series 8208

Selection Table

Version	Assembly	Description	Order number	Weight kg
 8208/24 Potentiometer	8208A0096-24-08	Resistance values see add. to ordering code	8208/24-08-	0.090

Order Number Supplement

Other resistance values for 8208/24-08-....	100 Ω 100 kΩ 1MΩ 220 Ω 2.2 kΩ 22 kΩ 220 kΩ 2.2 MΩ 470 Ω 47 kΩ 470 kΩ 4.7 MΩ	8208/24-08-0K10 8208/24-08-0M10 8208/24-08-01M0 8208/24-08-0K22 8208/24-08-02K2 8208/24-08-022K 8208/24-08-0M22 8208/24-08-02M2 8208/24-08-0K47 8208/24-08-047K 8208/24-08-0M47 8208/24-08-04M7	
Example: Potentiometer with resistance value 100 Ω:		8208/24-08-0K10	

Selection Table

Version	Assembly	Description	Order number	Weight kg
 8602 Actuators	8602A0092-1-006	with scale: 0 - 6	155438	0.030
	8602A0092-1-010	with scale: 0 - 10	155439	0.030
	8602A0092-1-100	with scale: 0 - 100	155440	0.030

Explosion Protection

Marking

IECEX	Ex de IIC, Ex de I Tamb - 55 ... + 40 °C
Europe (ATEX)	Ex II 2 G EEx de IIC / I M 2 Ex de I

Certificates

IECEX	IECEX PTB 06.0032U
Europe (ATEX)	PTB 01 ATEX 1066 U
Other certificates	India (PESO), Canada (CSA), Belarus (Gospromnadzor)

Technical Data

Electrical data

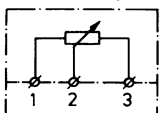
Max. permissible voltage	max. 450 V DC
Rated operational power	2 W
Resistance values	100 Ω ... 4,7 MΩ
Characteristic curve	linear
Resistance tolerance	± 20 %
Resistor material	Carbon composition
Circuit diagram	

Stop strength	≥ 100 Ncm
---------------	-----------

06065E00

Potentiometer

Series 8208



Technical Data

Ambient conditions

Ambient temperature | - 55 ... + 40 °C

Mechanical data

Enclosure material | Polyamide
 Rotation range | 270 °
 Torque | 0,7 ... 2 Ncm
 Connection type | 2 x 2,5 mm² flexible

Note

The switching capacity of the line side fuse of the potentiometer must be equal or larger than the maximum short circuit current (max. 3xI_B acc. to IEC 60127-2-1).

Dimensional Drawings (All Dimensions in mm) - Subject to Alterations

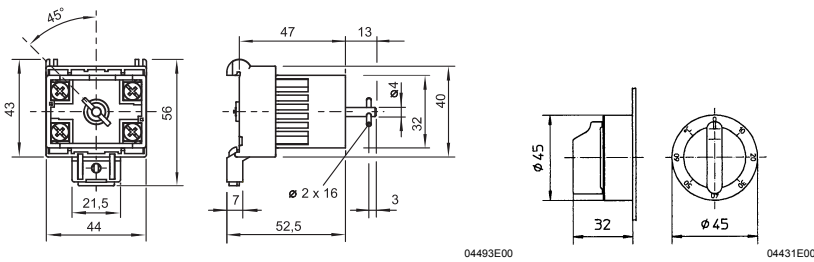

8208/24-08 Potentiometer

Potentiometer actuator
assembly code 92

E4

We reserve the right to make alterations to the technical data, weights, dimensions, designs and products available without notice. The illustrations cannot be considered binding.