

TYPE KC22J12T13, EQC632C

TRANSFORMER GROUND CONNECTORS

For Copper

Fits all standard EEI-NEMA distribution trans-
formers as a tank grounding terminal.



CATALOG NUMBER	RANGES
KC22J12T13	8 Sol. - 2 Sol.
KC26	2 Sol. - 2/0 Str.
KC34J12T13	3/0 - 500 Str.
EQC632C	8 Sol. - 2 Str.

Both, one-wrench installation.

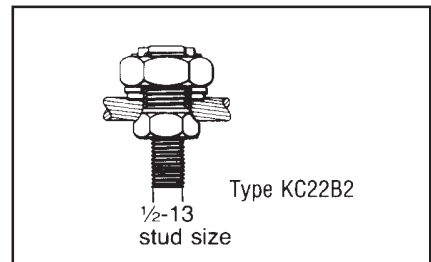

E-40

TYPE YA-2LH

HYSEALUG

Terminal for Copper

Tin-plated, pure copper 2-hole NEMA com-
pression terminal with shrouded barrel
for terminating insulated copper conductor to
transformers and other equipment. Shroud
prevents seepage of water or moisture into
conductor strands and minimizes taping.

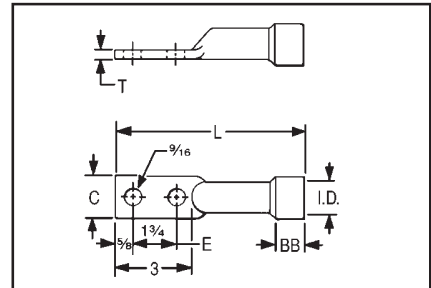

CATALOG NUMBER	CONDUCTOR	BB	SHROUD INSIDE DIA.	C	L	T	TOOLS, DIE SET CATALOG NUMBER, & (NUMBER OF CRIMPS)	
							MD7, MD6	Y35, Y750, Y45†, Y46‡
YAB4C-2LH72	4 Str.	5/8	.57	3/4	6-1/4	1/8	W161 (2)	U4CRT (2)
YAB4C-2LH73			.84					
YAB2C-2LH74	2 Str.	3/4	.58	7/8	6-1/2	3/8	W162 (4)	U2CRT (2)
YAB2C-2LH75			.91					
YAB25-2LH70	1/0 Str.	1	.69	1	6-3/4	1/8	W163 (4)	U25RT (2)
YAB25-2LH71	2/0 Str.		.98					
YA26-2LH88	3/0 Str.	1	.73	1	6-1/4	1/8	W241 (2)	U26RT (2)
YA26-2LH89			1.04					
YA27-2LH97	4/0 Str.	1-1/4	.84	1-1/4	7	1/4	W243 (2)	U27RT (2)
YA27-2LH98			1.06					
YA28-2LH114	250	1-1/4	.86	1-3/8	7-5/8	1/8	W-BG or W243 (2)	U28RT (2)
YA28-2LH115			1.24					
YA29-2LH90	300	1-1/2	.88	1-1/2	7-3/4	1/4	W166 (4)	U29RT (2)
YA29-2LH91			1.25					
YA30-2LH85	350	1-1/2	.92	1-1/2	7-3/4	1/4	—	U30RT (2)
YA30-2LH86			1.32					
YA31-2LH89	500	1-1/2	1.03	1-1/2	7-3/4	1/4	W-O (5)	U31RT (2)
YA31-2LH90			1.40					
YA34-2LH110	500	1-1/2	1.14	1-1/2	7-3/4	1/4	—	U34RT (2)
YA34-2LH111			1.88					

† U Die with adapter PT-6515
‡ U Die with adapter PUADP-1.